

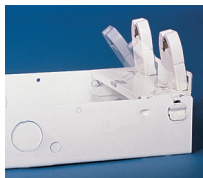

The CH Series is ideal for general purpose lighting in retail stores and commercial environments. Available in 2', 3', and 4' individual lengths as well as continuous row mounting.



CHT



Flip-up sockets

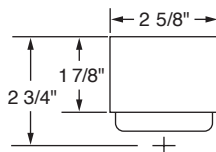

Dimensions

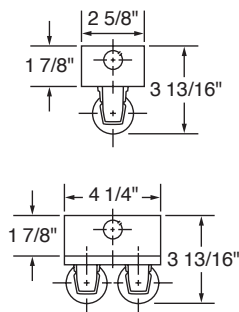

Housing

Die-formed heavy gauge steel with high-gloss, baked white enamel finish over rust inhibiting phosphate coat with removable wireway access panel. Ample knockouts provided on side, back and ends. Shipped fully wired and assembled, including socket saddle. Simply flip up socket bar and attach wireway cover with turn fastener provided. Machine installed shunts eliminate loose socket bar connections on electronic strips.

Options

Modular wiring, white or silver asymmetric or symmetric reflectors, and emergency lighting battery packs are available options.

Electrical

Fully wired for UNV 120-277V, 50-60Hz operation with thermally protected, automatic resetting Class P, sound rated A ballast as standard unless otherwise specified. UL listed damp location.

Mounting

Combination end plate/joiner connect units for continuous row or wire through, see CHJ on page 95. Optional plug-in wiring system described in detail on page 94.

CH Original Striplite Ordering Information

Series	# Lamps	Lamps	
CH	1	14 = 14W 15" T12	28 = 28W T5
	2	14 = 14W 24" T5	30 = 30W 36" T12
	4	15 = 15W 18" T8/T12	32 = 32W 48" T8
	21 = Tandem, two lamps	17 = 17W 24" T8	39 = 39W 36" T5HO
	22 = Tandem, four lamps	20 = 20W 24" T12	40 = 34/40W 48" T12
		21 = 21W 36" T5	40TT = 40W 22" TT
		24 = 24W 24" T5HO	54 = 54W T5HO
		25 = 25W 36" T8	

ELS Options	Ballast	Switching	Voltage
ELS1 = Emergency Lighting (low lumens)	B5 = Electronic T12	For 4 lamp units	UNV = 120-277V
ELS2 = Emergency Lighting (medium lumens)	B11 = Electronic T8	Blank = dual ballasts	120 = 120V
ELS3 = Emergency Lighting (high lumens)	B11HP(x) = HPT8*	4L = (1) 4-lamp ballast	277 = 277V
	B12 = Electronic T5		
	B14 = Electronic TT	For 2 lamp units	
	B22 = LPF Electronic T8/T12	Blank = single ballast	
	D = Dimming (specify ballast)	2/1L = (2) 1-lamp ballasts	

*CEE listed T8; specify (L)ow, (N)ormal, or (H)igh ballast factor. Contact factory for NEMA Premium.

Options	Accessories
Cord and Plug	Reflectors (Not compatible with wire guards)
CPT(x) (Twist + Lock)	<i>Symmetric</i>
1 = 120V	SR(x)(y)20 = 24"
2 = 277V	SR(x)(y)30 = 36" (Order 2 for tandem 72" units)
CP3 = Cord & Plug - 120V	SR(x)(y)40 = 48" (Order 2 for tandem 96" units)
Straight Blade 5-15P	<i>Asymmetric</i>
Plug-in Connectors	AR(x)20 = 24"
<i>Ballast wired to Black:</i>	AR(x)30 = 36" (Order 2 for tandem 72" units)
PL1 - one circuit, two wires	AR(x)40 = 48" (Order 2 for tandem 96" units)
PL2 BK - two circuits, three wires	
<i>Ballast wired to Red:</i>	(x) Enter (W) for white or (S) for specular aluminum
PL2 RD - two circuits, three wires	(y) Enter # lamps (1 or 2)
FB = Fast blow fuse	AC = Alignment Clips
SB = Slow blow fuse	CA24 = Chain Hanger Assembly - (2) 18" chains, (2) "V" hooks, (2) "S" hooks for total drop 24"
BP = Bulk Pack	CS24 = "S" Hook (4) Chain Hanger Assembly (24" total drop)
	PM(x) = Pendant Mount, white stem - specify length in inches (24, 36, 48, 60, 72)
	C = Single white canopy (for use with pendant mount)
	CHJ = Housing Joiner
	SN = Snapper Brackets
	WG(x)20 = 24" (Specify # Lamps) (1 or 2)
	WG(x)30 = 36" (Specify # Lamps) (1 or 2)
	WG(x)40 = 48" (Specify # Lamps) (1 or 2)