

#6 X 1/2" FLAT HEAD
MOUNTING SCREW

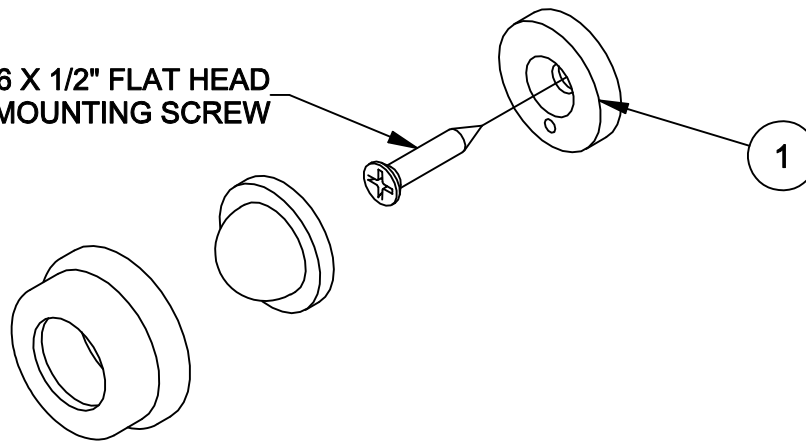

INSTALLATION INSTRUCTIONS:

1. REMOVE BACK PLATE (ITEM 1 ABOVE) BY UNSCREWING IT FROM THE BODY.
2. DRILL HOLE FOR PLASTIC BANTAM (SUPPLIED) WHEN LOCATION FOR BUMPER IS IDENTIFIED. USE A Ø1/4 INCH DRILL BIT. INSERT BANTAM.
3. MOUNT BACK PLATE LOOSELY AND MARK SPOT FOR NAIL (SHOULD BE 1/4 INCH OVER FROM CENTER HOLE). REMOVE BACK PLATE.
4. DRILL HOLE FOR FIBER RAWL PLUG (#6 X 1") USING Ø3/16 INCH DRILL BIT. INSERT FIBER RAWL PLUG.
5. REINSTALL BACK PLATE WITH SCREW (#6 X 1/2" FH PH WS) - SECURE TIGHTLY, INSERT AND DRIVE NAIL (#16 X 5/8" PIN) INTO FIBER RAWL PLUG. *NOTE - NAIL NOT SHOWN IN ILLUSTRATION ABOVE.
6. SCREW BODY OVER BACK PLATE - MAKE SURE BUMPER IS INSERTED INTO BODY PRIOR TO INSTALLATION.